

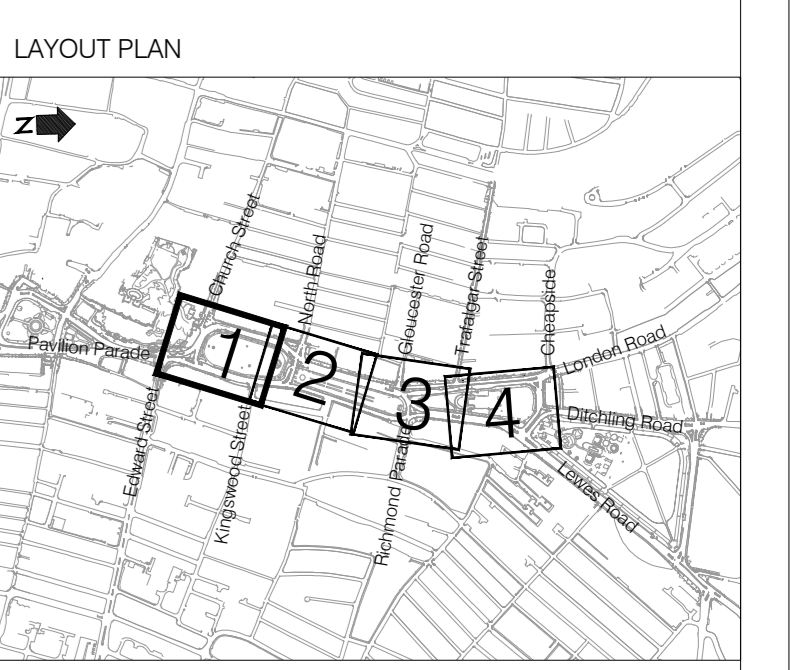

### LEGEND

- Proposed granite kerb (300 mm wide)
- Existing kerb
- Existing kerb to be retained
- Red tactile paving for controlled crossings
- Red tactile paving for controlled crossings
- Corduroy PPC blocks
- Proposed white roadmarking
- Proposed yellow roadmarking
- Approximate highway boundary
- Scheme extents
- Existing gully, adjust frame & grate
- Proposed gully
- Proposed footway gully
- Proposed tree
- Proposed tree in a Bento Box with a bench
- Off street, segregated cycle track/Cycle link
- Self binding gravel
- Green verges/shrubs
- Permeable Aquata clay blocks square edged
- Silver-gray granite blocks
- Reinforced PCC flag paving 600x750
- Other footway areas PCC flag paving 600x750
- Granite sets - match existing
- PPC cycle lane marker block 200mm wide by Marshalls
- PCC channel 255mm wide
- PCC edge 50mm wide
- Existing tree to be removed
- Proposed streetlight and post
- Proposed footway lamp and post
- Proposed Belisha beacon
- Proposed cycle stand
- New clear channel bus shelter
- New traffic signal primary, secondary and pedestrian push button
- Proposed bin locations

- Notes:
- Lighting and signal locations are indicative only and are to be confirmed by BHCC engineers
  - Refer to Unfilled Practice drawings for designs within the green spaces



Rev	Date	Description	By	Chk	App
E	11.11.2016	STAGE 3 UPDATE FOR REVIEW SPANSE ADDED	VB	AZ	AZ
D	31.10.2016	STAGE 3 UPDATE	VB	AZ	AZ
C	6.9.2016	STAGE 3 DRAFT FOR CIRCULATION	VB	SC	SC
B	30.6.2016	DESIGN AT STAGE 3 INCEPTION	VB	SC	SC
A	1.6.2015	STAGE 3 DESIGN AMENDMENTS	VB	SC	WC
-	5.5.2015	ISSUED FOR BHCC APPROVAL	VB	SC	WC

**PROJECT CENTRE**

4th Floor Westgate House  
Westgate, Ealing, London W5 1WY  
Tel: +44 (0)20 7421 8222  
Fax: +44 (0)20 7421 8199  
Email: info@projectcentre.co.uk

**Client**  
Valley Gardens & Bents  
City Council

**Project**  
VALLEY GARDENS  
STAGE 3 DESIGN

**Drawing Title**  
GENERAL ARRANGEMENT  
SHEET 1 OF 4

**Drawing Status**  
FOR REVIEW

**Drawn**  
VB

**Designed**  
SC

**Date**  
11.11.2016

**Scale**  
1:200

**Rev**  
AD

**Drawing No**  
1000002315-3-S010-01

**Rev**  
E



### LEGEND

- Proposed granite kerb (300 mm wide)
- Existing kerb
- Existing kerb to be retained
- Red tactile paving for controlled crossings
- Red tactile paving for controlled crossings
- Corduroy PPC blocks
- Proposed white roadmarking
- Proposed yellow roadmarking
- Approximate highway boundary
- Scheme extents
- Existing gully, adjust frame & grate
- Proposed gully
- Proposed footway gully
- Proposed tree
- Proposed tree in a Bento Box with a bench
- Off street, segregated cycle track/Cycle link
- Self binding gravel
- Green verges/shrubs
- Permeable Aquata clay blocks square edged
- Silver-gray granite blocks
- Reinforced PCC flag paving 600x750
- Other footway areas PCC flag paving 600x750
- Granite sets - match existing
- PPC cycle lane marker block 200mm wide by Marshalls
- PCC channel 255mm wide
- PCC edge 50mm wide
- Existing tree to be removed
- Proposed streetlight and post
- Proposed footway lamp and post
- Proposed Belisha beacon
- Proposed cycle stand
- New clear channel bus shelter
- New traffic signal primary, secondary and pedestrian push button
- Proposed bin locations

- Notes:
- Lighting and signal locations are indicative only and are to be confirmed by BHCC engineers
  - Refer to Unfilled Practice drawings for designs within the green spaces

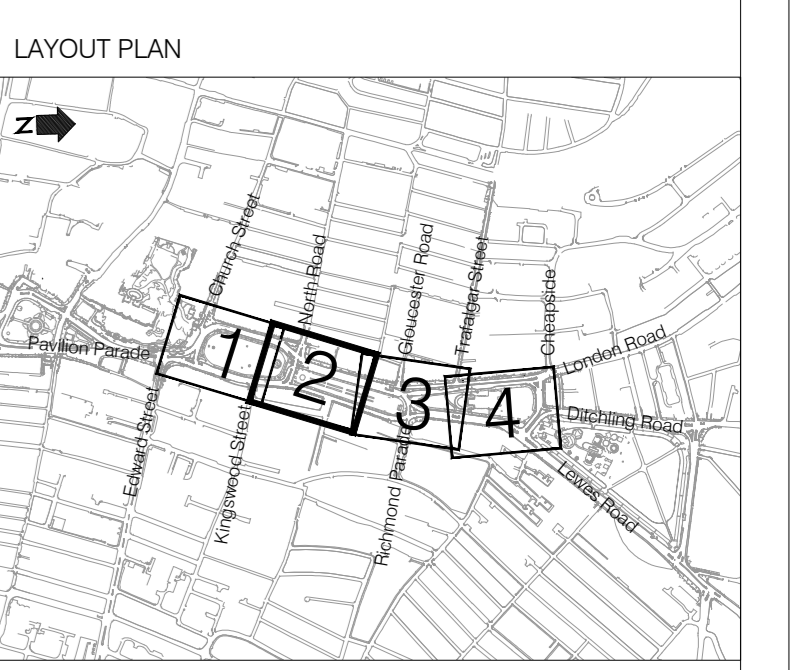

Rev	Date	Description	By	Chk	App
E	11.11.2016	STAGE 3 UPDATE FOR REVIEW SPACE ADDED	VB	AZ	AZ
D	31.10.2016	STAGE 3 DRAFT UPDATE	VB	AZ	AZ
C	6.9.2016	STAGE 3 DRAFT FOR CIRCULATION	VB	SC	SC
B	30.6.2016	DESIGN AT STAGE 3 INCEPTION	VB	SC	SC
A	1.6.2015	STAGE 3 DESIGN AMENDMENTS	VB	SC	WC
Rev	5.5.2015	ISSUED FOR BHCC APPROVAL	VB	SC	WC

**PROJECT CENTRE**

4th Floor, Westgate House  
Westgate, Ealing,  
London W5 1W  
Tel: +44 (0)20 7421 8222  
Fax: +44 (0)20 7421 8199  
Email: info@projectcentre.co.uk

Client: VALLEY GARDENS STAGE 3 DESIGN

Project: VALLEY GARDENS STAGE 3 DESIGN

Drawing Title: GENERAL ARRANGEMENT SHEET 2 OF 4

Drawing Status: FOR REVIEW

Drawn: VB | Designed: SC | Date: 11.11.2016 | Scale: 1:200 | Size: A0

Drawing No: 1000002315-3-SK010-02 | Rev: E

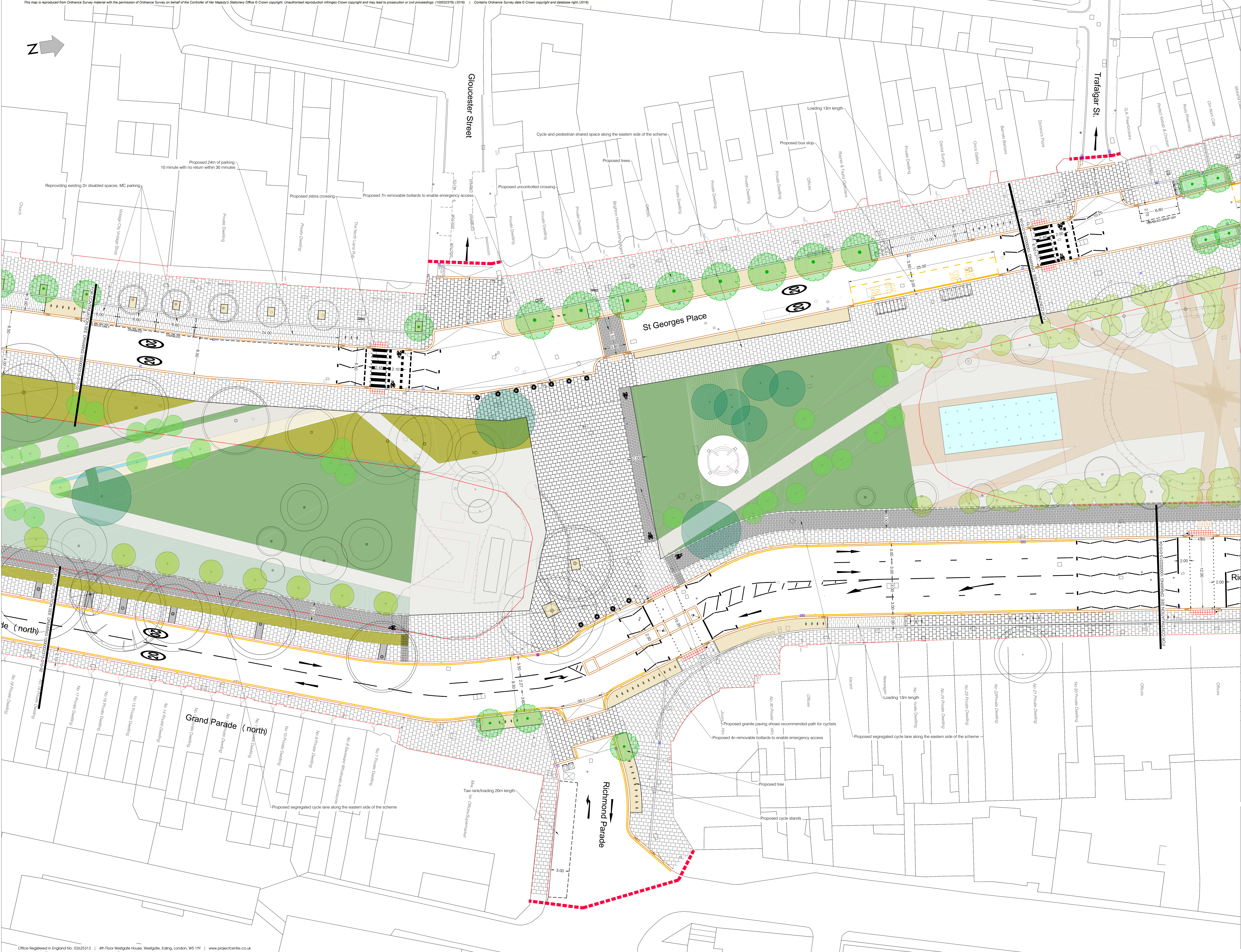

**LEGEND**

- Proposed granite kerb (300 mm wide)
- Existing kerb
- Existing kerb to be retained
- Red tactile paving for controlled crossings
- Red tactile paving for controlled crossings
- Corduroy PPC blocks
- Proposed white roadmarking
- Proposed yellow roadmarking
- Approximate highway boundary
- Scheme extents
- Existing gully, adjust frame & grate
- Proposed gully
- Proposed footway gully
- Proposed tree
- Proposed tree in a Benjo Box with a bench
- Off street, segregated cycle track/Cycle link
- Self binding gravel
- Green verges/shrubs
- Permeable Aquata clay blocks square edged
- Silver-grey granite blocks
- Reinforced PCC flag paving 600x750
- Other footway areas PCC flag paving 600x750
- Granite sets - match existing
- PCC cycle lane marker block 200mm wide by Marshalls
- PCC channel 255mm wide
- PCC edge 50mm wide
- Existing tree to be removed
- Proposed streetlight and post
- Proposed footway lamp and post
- Proposed Belisha beacon
- Proposed cycle stand
- New clear channel bus shelter
- New traffic signal primary, secondary and pedestrian push button
- Proposed bin locations

**Notes:**

1. Lighting and signal locations are indicative only and are to be confirmed by BHCC engineers
2. Refer to Unfiled Practices drawings for designs within the green spaces

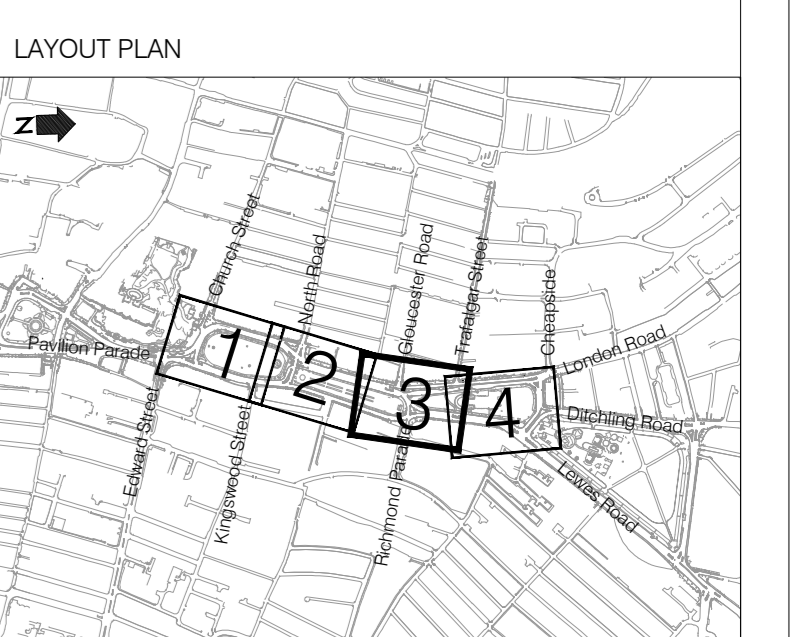

Rev	Date	Description	By	Chk	App
E	11.11.2016	STAGE 3 UPDATE FOR REVIEW SPANAGE ADDED	VB	AZ	AZ
D	31.10.2016	STAGE 3 DRAFT UPDATE	VB	AZ	AZ
C	6.9.2016	STAGE 3 DRAFT FOR CIRCULATION	VB	SC	SC
B	30.6.2016	DESIGN AT STAGE 3 INCEPTION	VB	SC	SC
A	1.6.2015	STAGE 3 DESIGN AMENDMENTS	VB	SC	WC
Rev	5.5.2015	ISSUED FOR BHCC APPROVAL	VB	SC	WC

**PROJECT CENTRE**

4th Floor, Westgate House  
Westgate, Ealing,  
London W5 1YJ  
Tel: +44 (0)20 7421 8222  
Fax: +44 (0)20 7421 8199  
Email: info@projectcentre.co.uk

**Client**

**Project**

VALLEY GARDENS  
STAGE 3 DESIGN

**Drawing Title**

GENERAL ARRANGEMENT  
SHEET 3 OF 4

**Drawing Status**

FOR REVIEW

Drawn	Designed	Date	Scale	Size
VB	SC	11.11.2016	1:200	A0
Drawing No.	1000002315-3-SK010-03			Rev
				E

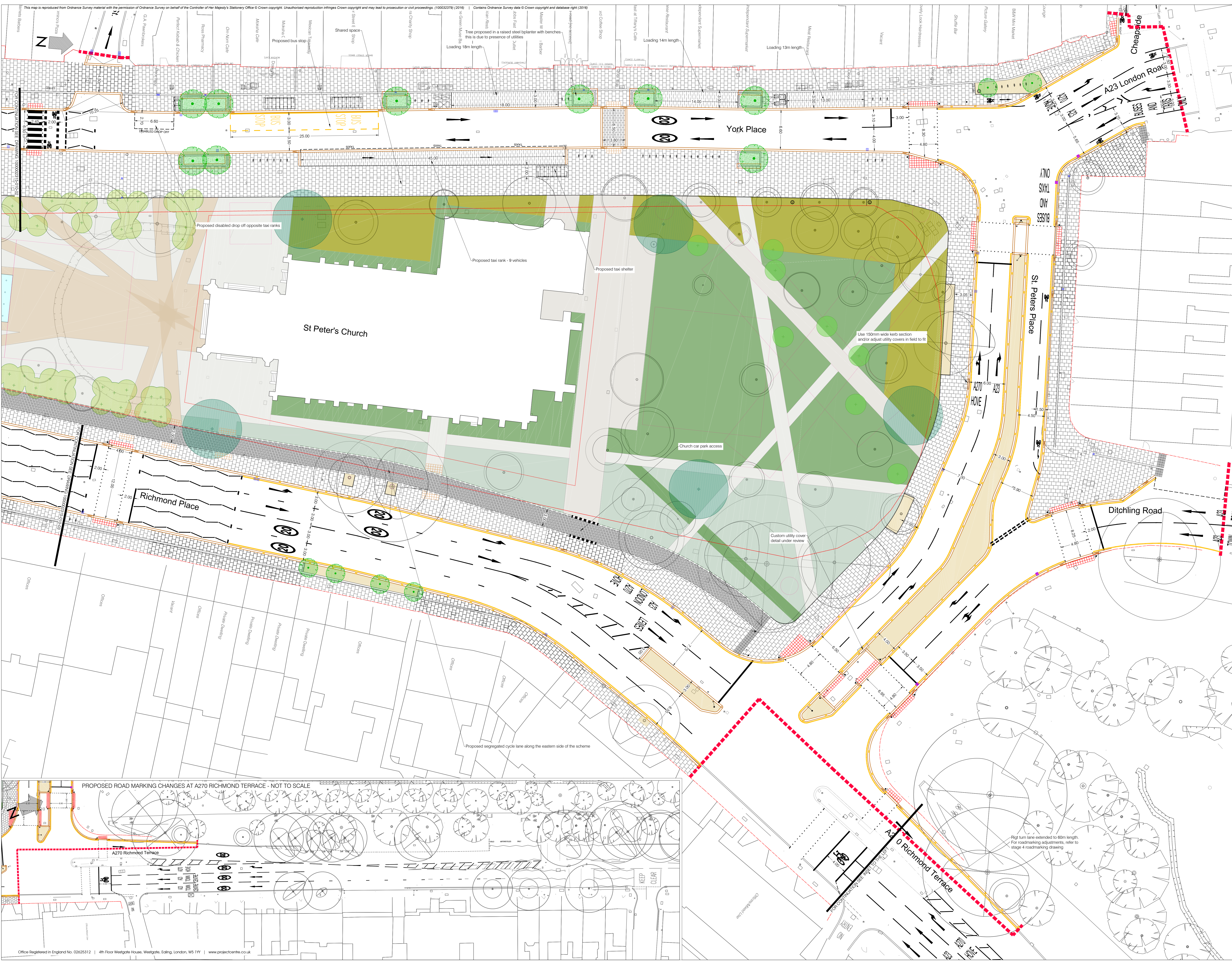

**LEGEND**

- Proposed granite kerb (300 mm wide)
- Existing kerb
- Existing kerb to be retained
- Red tactile paving for controlled crossings
- Red tactile paving for controlled crossings
- Corunna PPC blocks
- Proposed white roadmarking
- Proposed yellow roadmarking
- Approximate highway boundary
- Scheme extents
- Existing gully, adjust frame & grate
- Proposed gully
- Proposed footway gully
- Proposed tree
- Proposed tree in a Bento Box with a bench
- Off street, segregated cycle track/Cycle link
- Self binding gravel
- Green verges/shrubs
- Permeable Aquata clay blocks square edged
- Silver-gray granite blocks
- Reinforced PCC flag paving 600x750
- Other footway areas PCC flag paving 600x750
- Granite sets - match existing
- PPC cycle lane marker block 200mm wide by Marshalls
- PCC channel 255mm wide
- PCC edge 50mm wide
- Existing tree to be removed
- Proposed streetlight and post
- Proposed footway lamp and post
- Proposed Belisha beacon
- Proposed cycle stand
- New clear channel bus shelter
- New traffic signal primary, secondary and pedestrian push button
- Proposed bin locations

**Notes:**

- Lighting and signal locations are indicative only and are to be confirmed by BHCC engineers
- Refer to Unfiled Practice drawings for designs within the green spaces

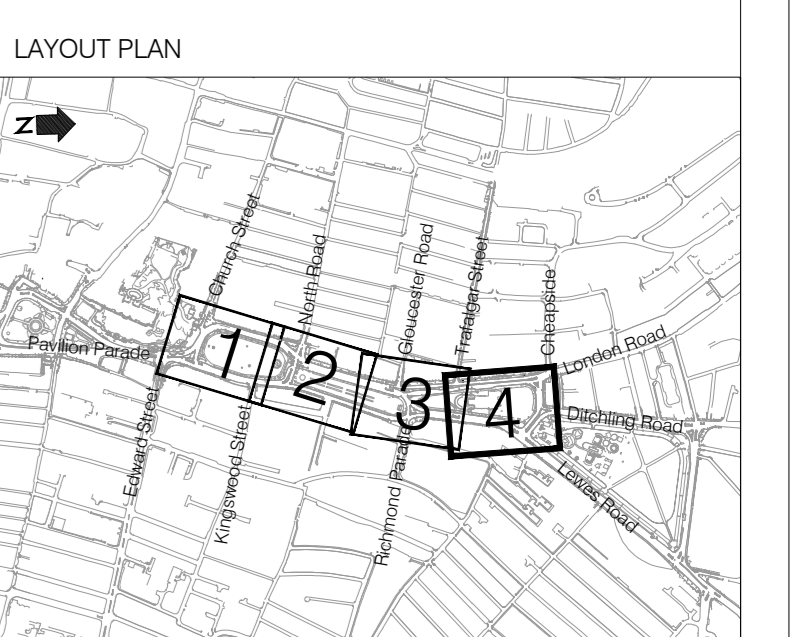

Rev	Date	Description	By	Chk	App
E	11.11.2016	STAGE 3 UPDATE FOR REVIEW SPANSE ADDED	VB	AZ	AZ
D	31.10.2016	STAGE 3 DRAFT UPDATE	VB	SC	AZ
C	6.9.2016	STAGE 3 DRAFT FOR CIRCULATION	VB	SC	SC
B	30.6.2016	DESIGN AT STAGE 3 INCEPTION	VB	SC	SC
A	1.6.2015	STAGE 3 DESIGN AMENDMENTS	VB	SC	WC
-	5.5.2015	ISSUED FOR BHCC APPROVAL	VB	SC	WC

**PROJECT CENTRE**

4th Floor, Westgate House  
Westgate, Ealing,  
London W5 1W  
Tel: +44 (0)20 7421 8222  
Fax: +44 (0)20 7421 8199  
Email: info@projectcentre.co.uk

**Client**  
Valley Gardens & Estate  
City Council

**Project**  
VALLEY GARDENS  
STAGE 3 DESIGN

**Drawing Title**  
GENERAL ARRANGEMENT  
SHEET 4 OF 4

**Drawing Status**  
FOR REVIEW

**Drawn** VB  
**Designed** SC  
**Date** 11.11.2016  
**Scale** 1:200  
**Rev** AD

**Drawing No** 1000002315-3-SK010-04  
**Rev** E

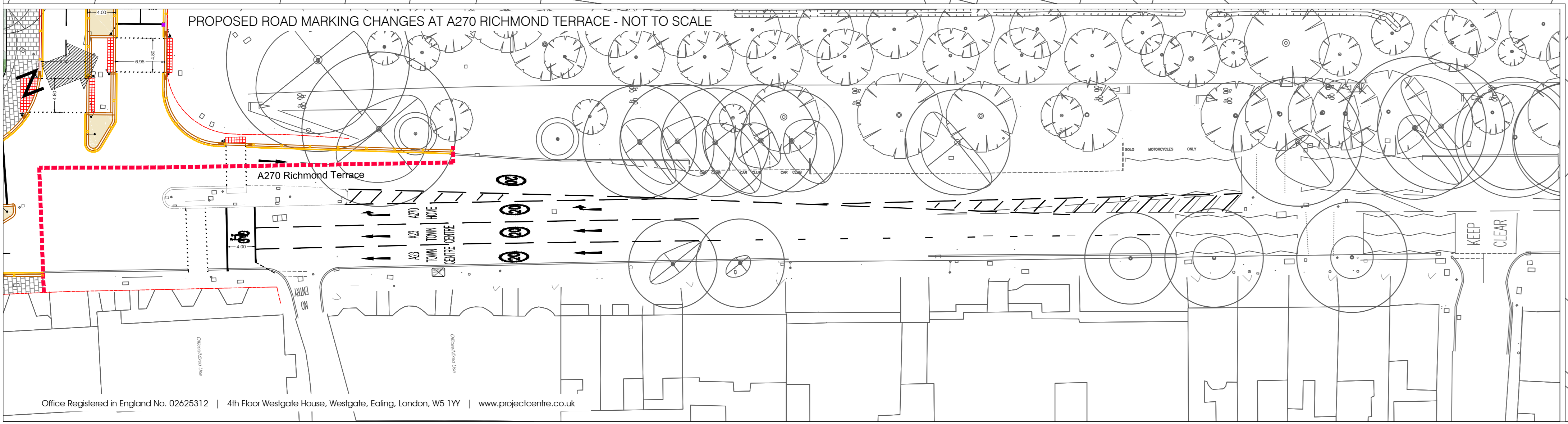



**LEGEND**

- Proposed granite kerb (300mm wide)
- Existing kerb
- Existing kerb to be retained
- Red tactile paving for controlled crossings
- Red tactile paving for controlled crossings
- Corduroy PPC blocks
- Proposed white roadmarking
- Proposed yellow roadmarking
- Approximate highway boundary
- Scheme extents
- Existing gully, adjust frame & grate
- Proposed gully
- Proposed footway gully
- Proposed tree
- Proposed tree in a Bento Box with a bench
- Off street, segregated cycle track/Cycle link
- Self binding gravel
- Green verge/shrub
- Permeable Aquata clay blocks square edged
- Silver-gray granite blocks
- Reinforced PCC flag paving 600x750
- Other footway areas PCC flag paving 600x750
- Granite sets - match existing
- PPC cycle lane marker block 200mm wide by Marshalls
- PCC channel 255mm wide
- PCC edge 50mm wide
- Existing tree to be removed
- Proposed streetlight and post
- Proposed footway lamp and post
- Proposed Belisha beacon
- Proposed cycle stand
- New clear channel bus shelter
- New traffic signal primary, secondary and pedestrian push button
- Proposed bin locations

**Notes:**

- Lighting and signal locations are indicative only and are to be confirmed by BHCC engineers
- Refer to Unified Practice drawings for designs within the green spaces

Rev	Date	Description	By	Chk	App
E	11.11.2016	STAGE 3 UPDATE FOR REVIEW SPANAGE ADDED	VB	AZ	AZ
D	31.10.2016	STAGE 3 UPDATE	VB	AZ	AZ
C	6.9.2016	STAGE 3 DRAFT FOR CIRCULATION	VB	SC	SC
B	30.6.2016	DESIGN AT STAGE 3 INCEPTION	VB	SC	SC
A	1.6.2015	STAGE 3 DESIGN AMENDMENTS	VB	SC	WC
-	5.5.2015	ISSUED FOR BHCC APPROVAL	VB	SC	WC

**PROJECT CENTRE**

4th Floor, Westgate House  
Westgate, Ealing, London, W5 1TY  
Tel: +44 (0)20 7421 8222  
Fax: +44 (0)20 7421 8199  
Email: info@projectcentre.co.uk

**Client**  
Valley Gardens & Green City Centre

**Project**  
VALLEY GARDENS  
STAGE 3 DESIGN

**Drawing Title**  
GENERAL ARRANGEMENT  
SHEET 4 OF 4

**Drawing Status**  
FOR REVIEW

**Drawn** VB  
**Designed** SC  
**Date** 11.11.2016  
**Scale** NTS  
**Rev** AD

**Drawing No.** 1000002315-3-SK010-04  
**Rev** E

